

Percutaneous Heartvalves

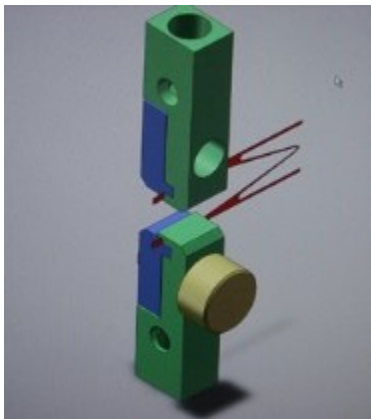
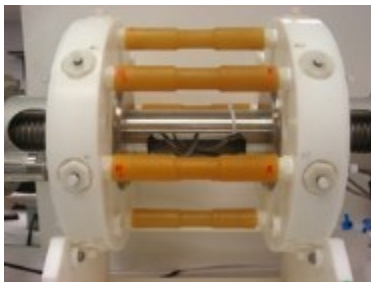

Percutaneous heart valves provide additional challenges for durability testing. These devices feature valve leaflets mounted to stents or ring-like structures. The leaflets experience bending strains in vivo while the outer structure experiences a radial strain. To test durability, the high localized strain areas of the design are initially tested at the component level (ie: leaflet roots or stent struts). This is then followed by a full device test once the design is finalized. MDT has a wide array of fixture designs for testing device components as well as large inventory of radial fatigue testers for testing the full devices.

Contact Us

Medical Device Testing
5929 Baker Road, Ste 430
Minnetonka, MN 55345

Ph: 952-933-1152
Fax: 952-933-1186
info@devicetesting.com
www.devicetesting.com

Durability Test Specialists

With more than 20 years of medical device testing experience, MDT will assist you in all aspects of your test program. Our staff has pioneered many new accelerated fatigue tests. Visit us on the web at www.devicetesting.com.